

STB-SZ

MALE-FEMALE SYSTEM

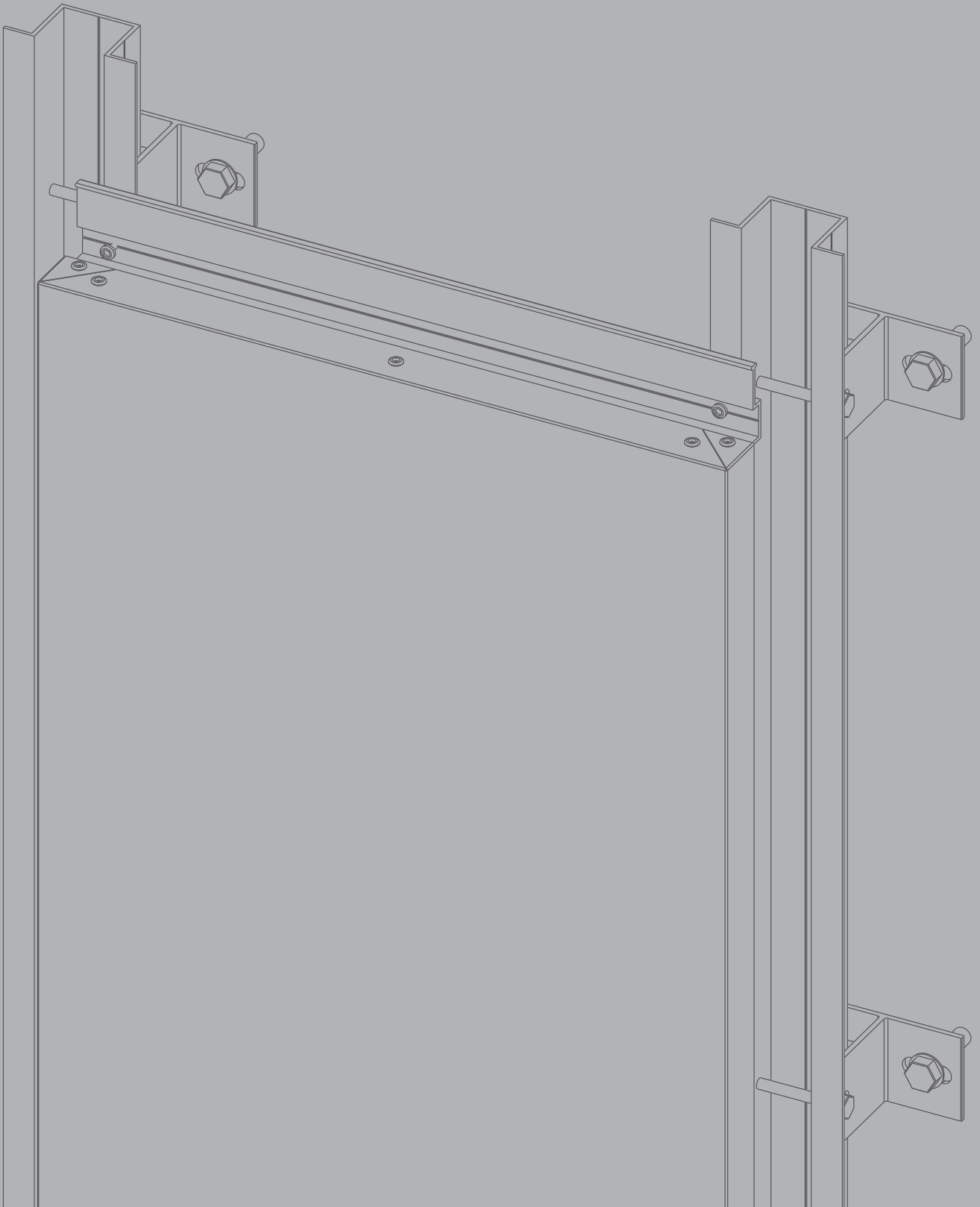

STB-SZ SYSTEM

DESCRIPTION



STB-T-SZ is a kit system based on cassettes made from **STACBOND® composite panels for installing ventilated facades**. It is a hidden male-female coupling system which is quick and easy to install. It was specially designed to develop facades with horizontal aspect of mainly solid wall with little surface area of openings or linear spaces.

The system comprises two 6063 T5 aluminium alloy profiles onto which the pre-formed cassettes are attached:

- Lower female profile, called **profile S**.
- Upper male profile, called **profile Z**.

The substructure employs **profiles OMEGA** and **spacers DOUBLE T** in 6063 T5 aluminium alloy.

The spacers come in various lengths to house the required thickness of thermal insulation and compensate any irregularities in the facade. For the thermal break, **STAC®** has developed specific **INSULATING WEDGES** to place between the spacers double T and the vertical face.

The spacers are anchored to the wall using special mechanical fixings, recommended in each case by the fixings suppliers, and receive the profiles OMEGA as uprights.

The **STACBOND®** composite panel cassettes are mechanically attached to the uprights. The facade is constructed from the base up in a manner that the profile S of each upper cassette sits on the profile Z of the cassette below it. Mechanical anchoring is via screwing the profiles Z to the profile OMEGA.

To avoid vibration of the male-female cassettes and the profiles S and Z, protective EPDM gaskets are incorporated.

STAC® has developed a program for the specific calculations of the substructure with the criteria from the Technical approval Document (DIT plus 553p/16) established by the Instituto de Ciencias de la Construcción Eduardo Torroja for each project executed, defining the maximum distances between uprights and the number of fixings.

The **STB-SZ** system complies with all major international certifications.



ETA-ETE: 15/0655



Nº 553P/16



ITB - KOT 2017/0043



ASOCIACIÓN MEXICANA DE VENTANAS Y CERRAMIENTOS

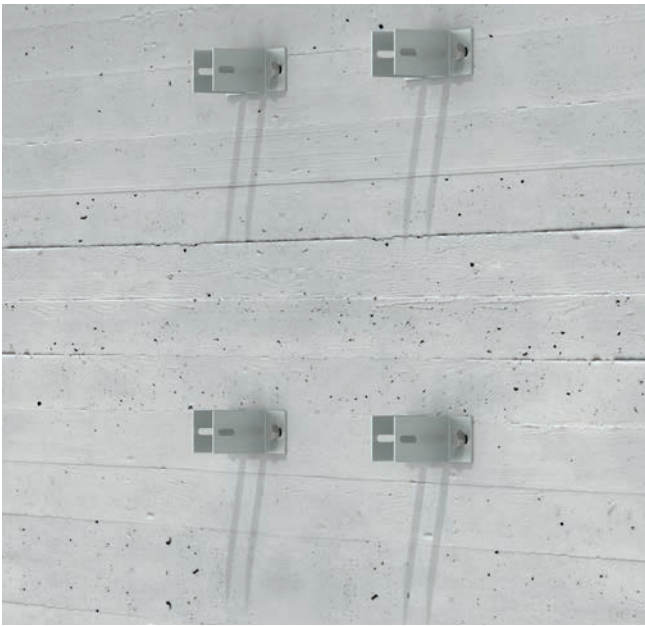

SPACERS DOUBLE T



PROFILES OMEGA

1. The first step is **attaching the spacers DOUBLE T** to the facade. These must be in perfect vertical alignment. The spacers to be used depends on the thermal insulation and the layout / irregularities of the facade. **Insulating wedges** can optionally be installed to act as thermal bridge breaks.

2. The **profiles OMEGA** are screwed to the **spacers DOUBLE T**. They must be perfectly plumb with the adjustment that the system allows. The first and last fixings must be placed at a maximum of 250 mm from the ends of the profile OMEGA.



BASE PROFILE Z



STACBOND COMPOSITE PANEL CASSETTES

3. Profile S and profile Z. These profiles longitudinally strengthen the cassette in both its upper and lower parts. The profile Z is fitted in the upper part and has a EPDM adhesive strip which surrounds the vertical wing of the profile to absorb possible spaces between the male and female parts to avoid noise caused by vibration. These profiles are attached to the cassettes using rivets.

4. STACBOND® composite panel cassette. Once the cassette has been formed with the profile Z in the upper part and the profile S in the lower part, it is set up to the facade. Cladding is performed from the bottom row up in a manner so that each cassette rests on the one below and is mechanically fastened in the upper part by screwing the profile Z to the upright profile OMEGA.

PROFILE S AND PROFILE Z



PROFILE S

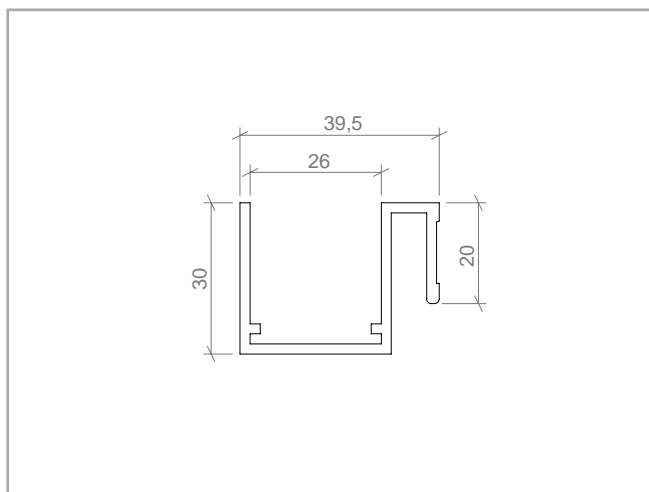

PROFILE Z

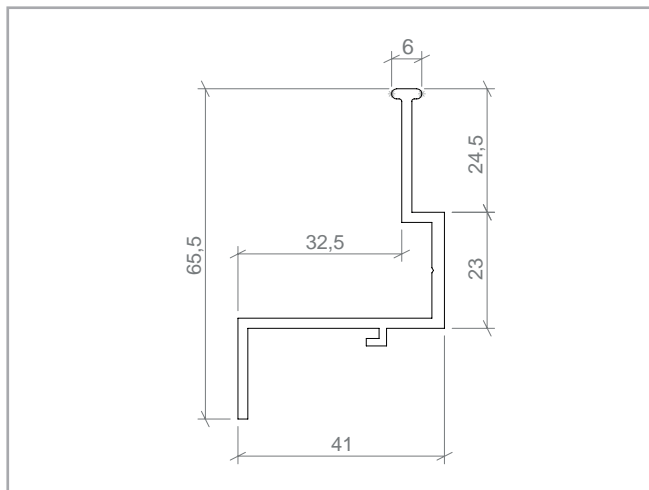

Measurements in mm

EPDM GASKET PROFILE SZ



We provide a EPDM protection gasket to place between the two profiles and absorb any slack.

REINFORCEMENT STB-SZ

The reinforcement STB-SZ is a segment of profile of 200 mm specific length, covers the internal distance between the SZ cassette and the substructure.

This part is attached to the substructure profile with screws.



REFERENCE	DESCRIPTION	UNITS/BOX
05.19.001	PROFILE S	24
05.19.002	PROFILE Z	18
05.99.231	REINFORCEMENT STB-SZ	174
STB-JEPDM	EPDM GASKET PROFILE SZ (m.l.)	-

USING THE EPDM GASKET PROFILE SZ

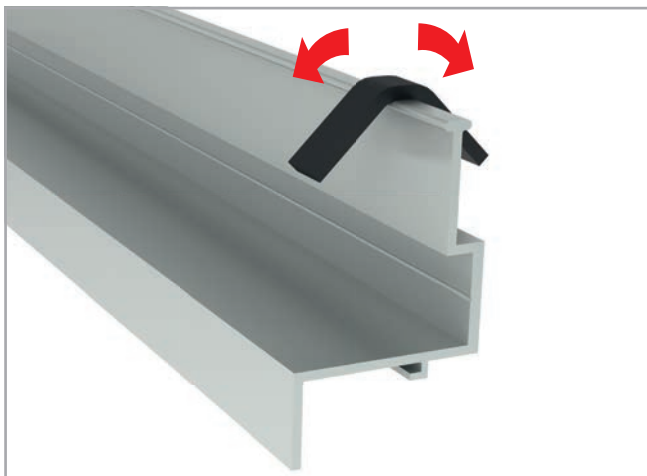

The segments of EPDM gasket must be placed on the head of the profile Z and wrapped around to cover both sides. The recommended size of these strips is 60 mm.



The recommended maximum distance between segments is 500 mm. Using this accessory eliminates possible vibrations between the panels and allows them to be adjusted to ensure flatness of the facade.

USING THE REINFORCEMENT STB-SZ

The use of the STB-SZ reinforcement depends on the height of the tray and the wind load of the project site. For more detailed information please consult STAC®.

It must be used on each of the upright profiles OMEGA that support the composite panel cassette.

The reinforcement is mechanically attached to the front face of the profile and special adhesive and double-sided adhesive tape is applied.

The cassette is then fitted and fixed using rivets in the upper profile Z.

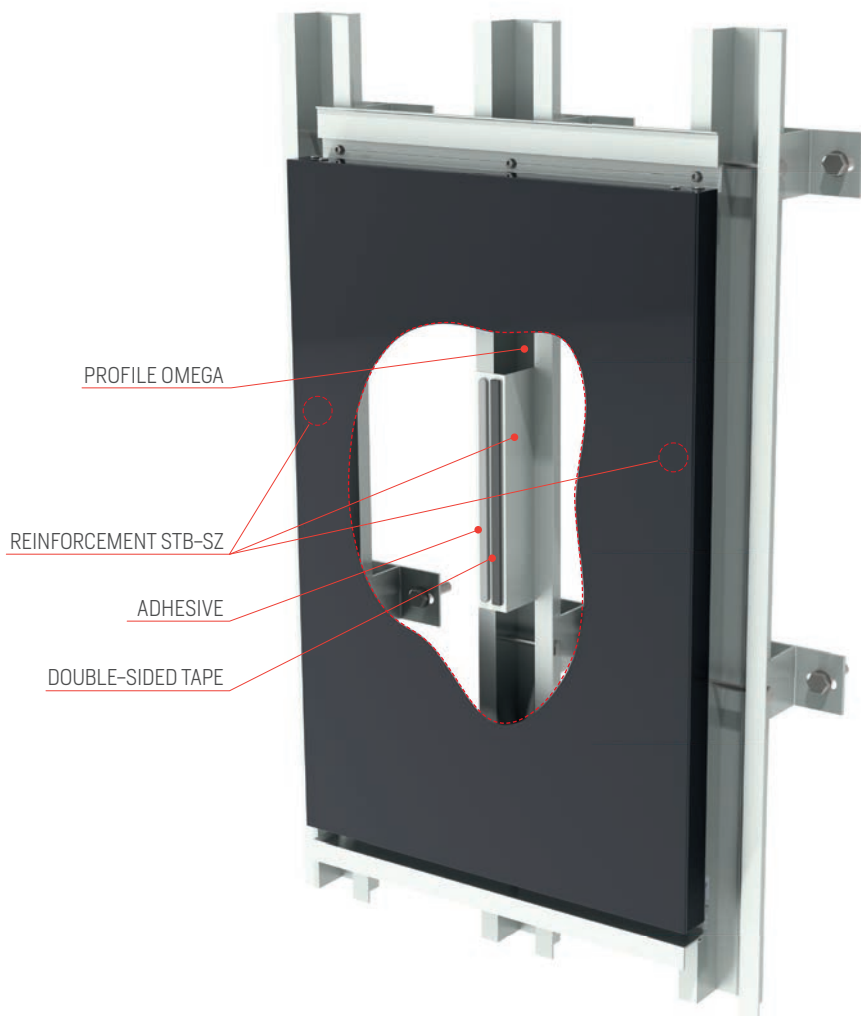

STB-SZ SYSTEM

INSTALLING SZ CASSETTE

UPPER FIXING



VERTICAL CROSS-SECTION

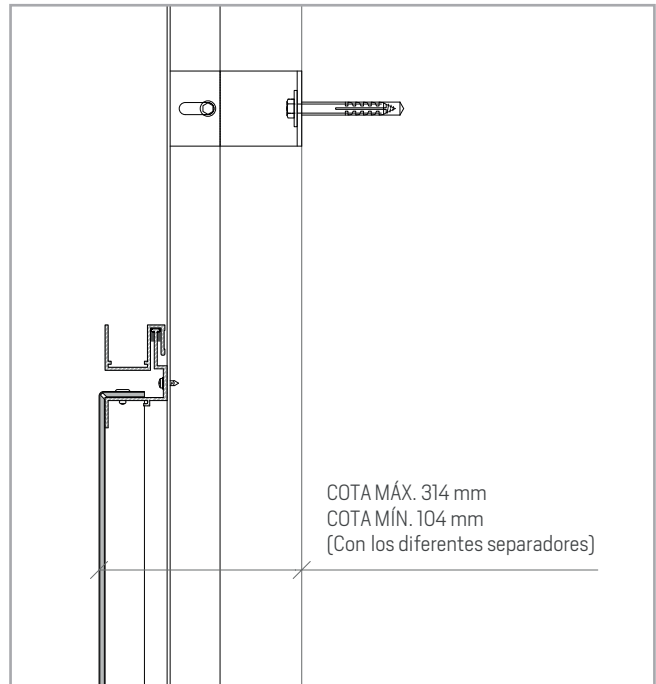

VERTICAL CROSS-SECTION

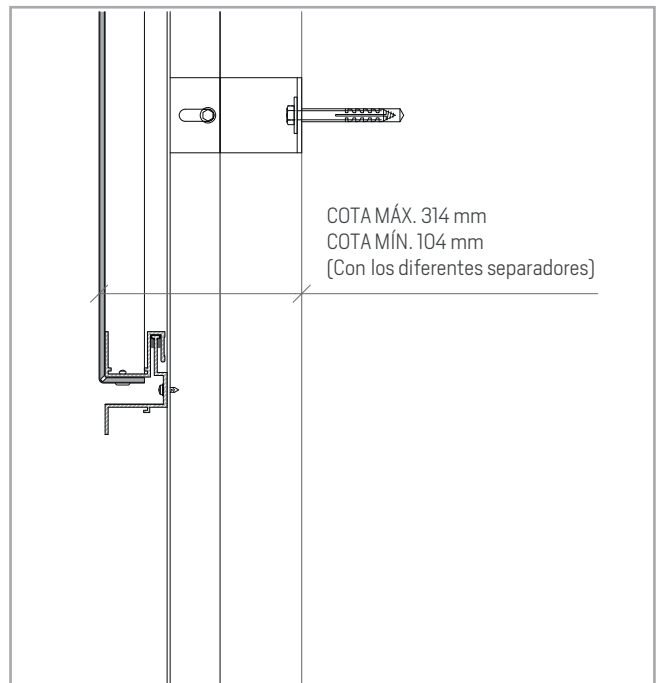

Note: The machined STACBOND® panels are supplied flat. The client is responsible for forming them into cassettes. No specialist machinery is required.

FORMED CASSETTE



FLAT CASSETTE

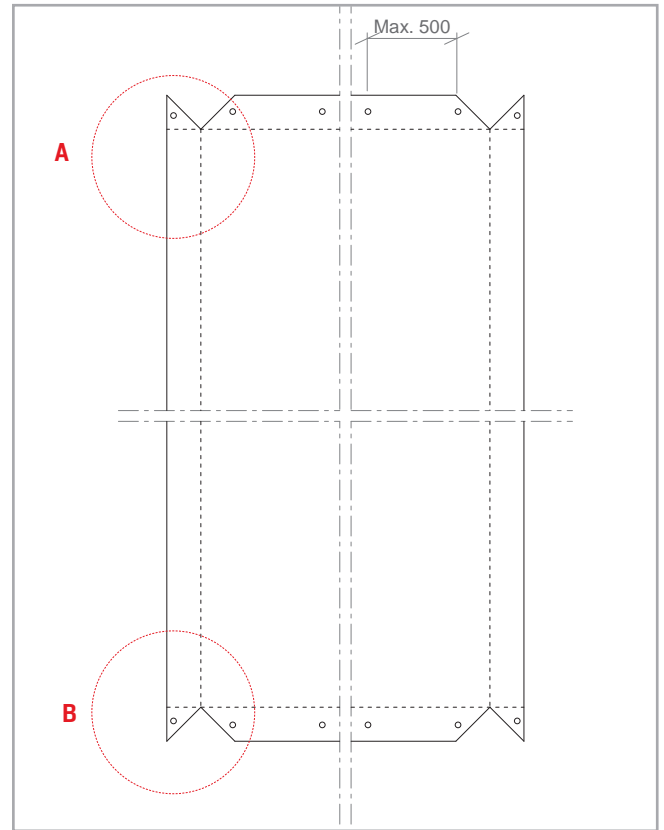

DETAIL A

DETAIL B

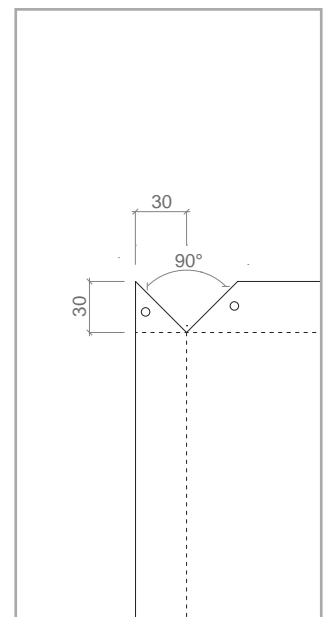
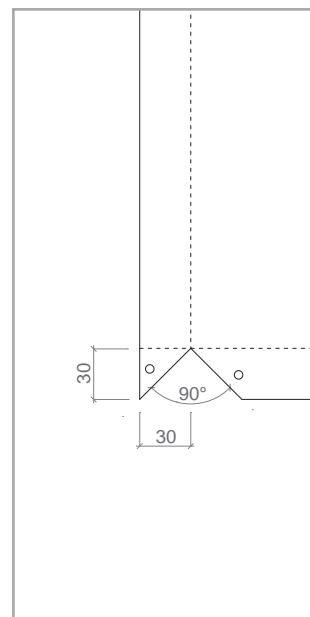

Measurements in mm

The standard cassettes in the STB-T-SZ system have 30 mm flaps. To form the cassettes, they are mechanically fastened via rivets directly to the longitudinal profiles S and Z.

The profile Z is attached in the lower part and the profile S in the upper part of the cassette. These profiles provide the cassettes with great longitudinal rigidity.

STB-SZ SYSTEM

INSTALLATION DIAGRAM

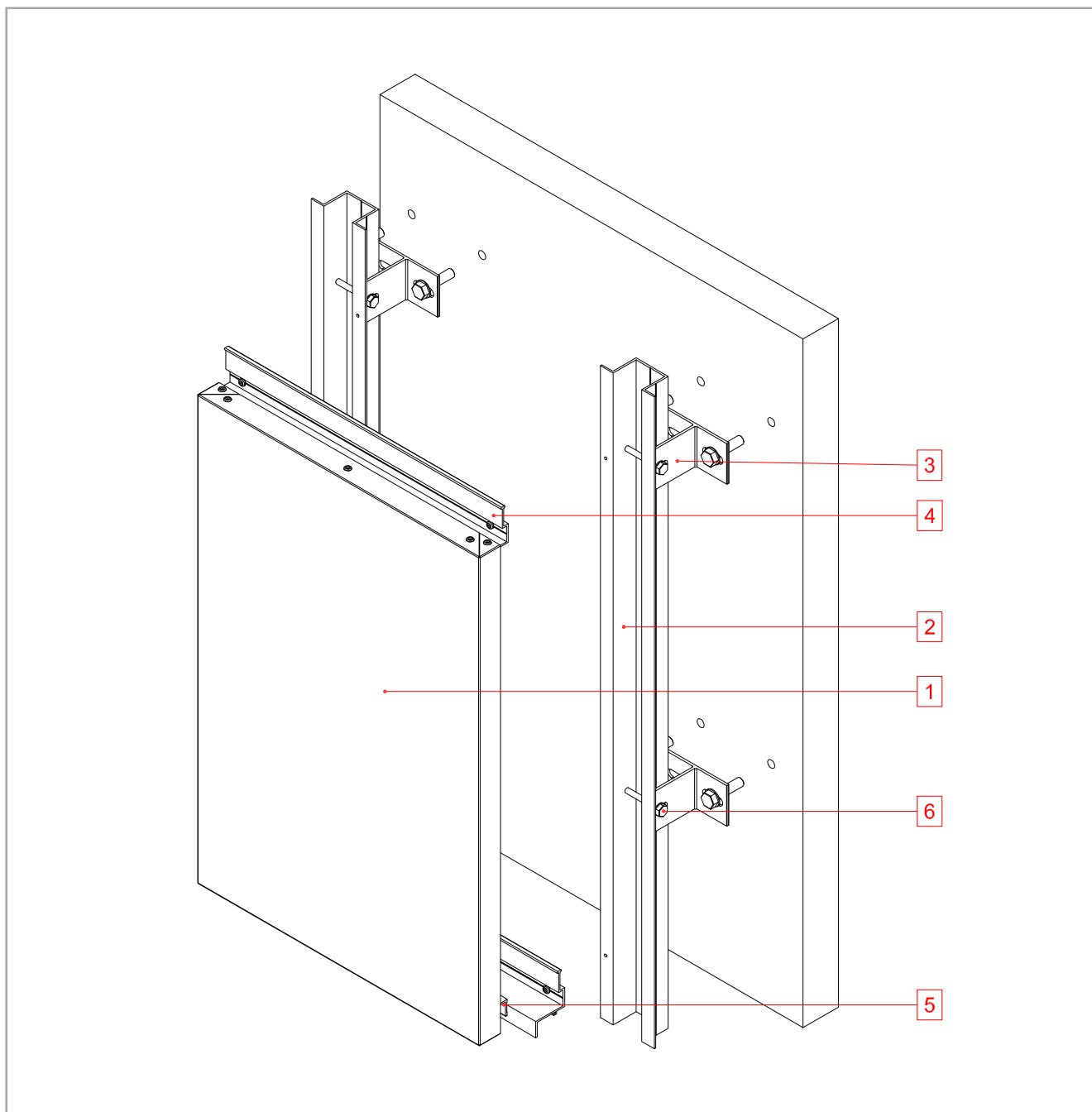

N° NAME

- | | |
|---|--|
| 1 | Cassette made from STACBOND® composite panel |
| 2 | Profile OMEGA |
| 3 | Spacer DOUBLE T |
| 4 | Profile Z |
| 5 | Profile S |
| 6 | Through screw M 6 x 60/70 |

STB-SZ SYSTEM

SPACER / THERMAL INSULATION RELATIONSHIP

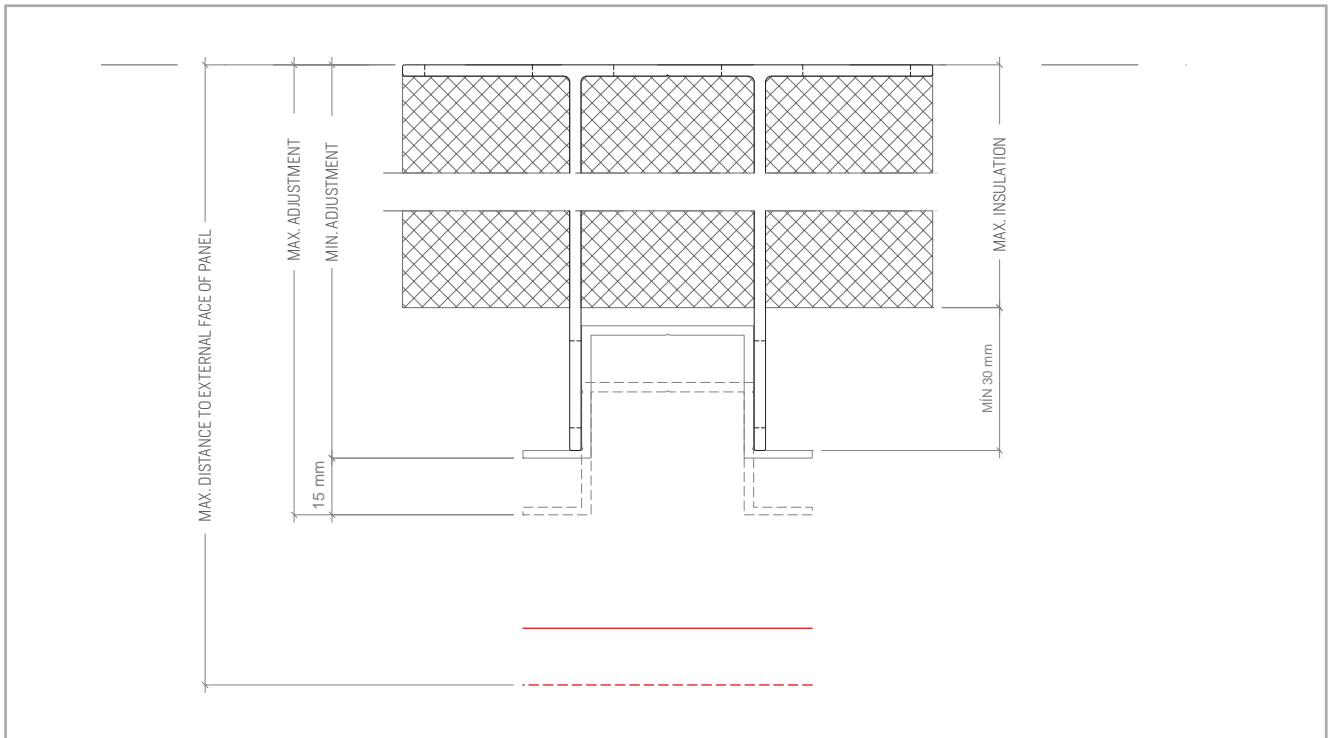

SPACER DOUBLE T *		DISTANCE (mm) FROM BASE OF FIXING TO VISIBLE FACE OF PANEL		RECOMMENDED INSULATION (mm) WITH 30 mm AIR CAVITY
REF.	PART	MIN.	MAX	
05.19.004	SPACER DOUBLE T 59	104	119	30
05.19.005	SPACER DOUBLE T 74	119	134	50
05.19.006	SPACER DOUBLE T 89	134	149	60
05.19.007	SPACER DOUBLE T 104	149	164	80
05.19.030	SPACER DOUBLE T 119	164	179	100
05.19.031	SPACER DOUBLE T 134	179	194	110
05.19.032	SPACER DOUBLE T 149	194	209	120
05.19.033	SPACER DOUBLE T 164	209	224	140
05.19.034	SPACER DOUBLE T 179	224	239	160
05.19.035	SPACER DOUBLE T 194	239	254	170
05.19.036	SPACER DOUBLE T 209	254	269	180
05.19.037	SPACER DOUBLE T 224	269	284	200
05.19.038	SPACER DOUBLE T 239	284	299	220
05.19.039	SPACER DOUBLE T 254	299	314	230

SPACER U *		DISTANCE (mm) FROM BASE OF FIXING TO VISIBLE FACE OF PANEL		RECOMMENDED INSULATION (mm) WITH 30 mm AIR CAVITY
REF.	PART	MIN.	MAX	
05.19.046	SPACER U 59	104	119	30
05.19.047	SPACER U 74	119	134	50

STB-SZ SYSTEM

ACCESSORIES

PROFILES

REF.	PART	PAGE
05.19.003	PROFILE OMEGA	106
05.19.001	PROFILE S	
05.19.002	PROFILE Z	107
05.19.074	PROFILE Z 20	
05.19.063	PROFILE Z 24	

AUXILIARY ELEMENTS

REF.	PART	PAGE
05.99.231	REINFORCEMENT STB-SZ	110
STB-JEPDM	EPDM GASKET PROFILE SZ (m.l.)	

INSULATING WEDGES

REF.	PART	PAGE
05.19.071	3 x GROOVE WASHER FOR INSULATING WEDGES WITH REF.: 05.19.067 / 05.19.069 / 05.19.073	
05.19.005	INSULATING WEDGE FOR SPACERS U* WITH REF.: 05.19.046 / 05.19.047	
05.19.069	INSULATING WEDGE FOR SPACERS DOUBLE T* WITH REF.: 05.19.030 / 05.19.031 / 05.19.032 / 05.19.033 / 05.19.034 / 05.19.035 / 05.19.036 / 05.19.037 / 05.19.038 / 05.19.039	114
05.19.073	INSULATING WEDGE FOR SPACERS DOUBLE T* WITH REF.: 05.19.004 / 05.19.005 / 05.19.006 / 05.19.007	

SPACERS

REF.	PART	PAGE
05.19.004	SPACER DOUBLE T 59	
05.19.005	SPACER DOUBLE T 74	
05.19.006	SPACER DOUBLE T 89	
05.19.007	SPACER DOUBLE T 104	
05.19.030	SPACER DOUBLE T 119	
05.19.031	SPACER DOUBLE T 134	
05.19.032	SPACER DOUBLE T 149	108
05.19.033	SPACER DOUBLE T 164	
05.19.034	SPACER DOUBLE T 179	
05.19.035	SPACER DOUBLE T 194	
05.19.036	SPACER DOUBLE T 209	
05.19.037	SPACER DOUBLE T 224	
05.19.038	SPACER DOUBLE T 239	
05.19.039	SPACER DOUBLE T 254	
05.19.046	SPACER U 59	109
05.19.047	SPACER U 74	

FASTENING ACCESSORIES

REF.	PART	PAGE
STB-R0300	BLIND RIVET POLYGRIP SFS ASO-D-48150 ALU/INOX 4,8X15	113

INFORMATION AND SALES

 (+34) 981 817 036

 (+34) 981 817 037

 stacbond@stac.es

 www.stac.es